

Product Data Sheet

Wallmount Charging Lockers, Basic Charging



UWL-10KD

Overview

Wallmount Charging Lockers, Basic Charging are ideal for smaller classrooms, offices, and training environments that are short on space. The Lockers hold 10 or 12 iPad® tablets or 15-inch Chromebook™ laptops. The lockers also give you the versatility to mount multiple lockers together for more storage options.

Configuration Options

- Store tablets or 15" Chromebook laptops.
- Holds up to 10 or 12 devices.
- Keyed locks or padlocks.
- Shelf and device divider protection.
- Separate locking power management drawer.

Features

- Save your floor space and secure and charge your devices in this compact locker measuring only 17"H x 21"W x 16"D. The locker can be wallmounted or placed on top of desks, tables, filing cabinets or shelves.
- Device count: Store 10 to 12 devices from iPad tablets to 15-inch Chromebook laptops, or other similarly sized devices.
- Create locker walls. Stack Lockers on top of each other or mount them side to side and back to back to create Locker walls and blocks.
- Super strong. 100% all-steel lockers hold up to 150 pounds.
- U.S.-built, in-stock, ready to ship. Get the fastest delivery in the industry.
- Power Management. The Lockers include a drawer for easy management of power bricks and wall warts. Lockers include one PDU.
- Safe and secure. The front door features two-point locking to secure devices. Padlocking is optional.
- Use and reuse. If your application changes, so can the Lockers. They feature adjustable-depth 19" rackmount rails so you can mount IT equipment for different uses.
- Wallmount on 16" and 19" C/C studs. Hardware included.
- Power management drawer can be ordered with separate lock for administrator access only.

Wallmount Charging Lockers, Basic Charging Data Sheet

Wallmount Charging Lockers, Basic Charging General Specifications

General	
Approvals	UL approved power strips
Use	Indoor office and mobile use only
Assembled	Yes
Material	18 ga (1.2 mm) minimum steel
Construction	Riveted & bolted panels
Finish	Powder Coat
Color	Gray
Electrical	
Input Power	120 VAC, 15 A, 50-60 Hz, 1 Ph
Input Power Cord	NEMA5-15P plug, min. 6-ft. (1.8-m) cord
Power Cord Access	(2) 1.3" (3.3-cm) DIA holes (Back and Right rear bottom corner)
On/Off Switch	(1) illuminated switch on PDU
Device Charging Type	(1) PDU w/ 12 total NEMA 5-15R outlets
Auxillary Power	No
Dimensions	
Unit Height	17" (43.2 cm)
Unit Width	21" (53.3 cm)
Unit Depth	16" (40.6 cm)
Unit Weight	30 lb. (13.6 kg)
Shipping Height	21" (53.3 cm)
Shipping Width	25" (63.5 cm)
Shipping Depth	20" (50.8 cm)
Shipping Weight	40 lb. (18.2 kg)
Frame	
Ventilation	Min. 75% high flow steel mesh, (2) places per shelf
Warranty	
Cart	1 Year
Electronics	1 Year

Wallmount Charging Lockers, Basic Charging Specifications

Part Number	Typical Device	Device Quantity	Lock Type	Separate Locking Drawer	Max. Device Size (inches)			Max. Wallmount Power Supply Size (inches)			Max. Power Brick Size (inches)		
					Height	Width	Depth	Height	Width	Depth	Height	Width	Depth
UWL-10KD	Chromebook	10	Key lock	No	12.5	1.48	13.9	3.1	1.1	2.8	3	1.8	5.5
UWL-10PD	Chromebook	10	Padlock	No	12.5	1.48	13.9	3.1	1.1	2.8	3	1.8	5.5
UWL-12KD	Chromebook	12	Key lock	No	12.5	1.2	13.9	3.1	1.1	2.8	3	1.5	5.5
UWL-12PD	Chromebook	12	Padlock	No	12.5	1.2	13.9	3.1	1.1	2.8	3	1.5	5.5
UWL-10KLD	Chromebook	10	Key lock	Yes	12.5	1.48	13.9	3.1	1.1	2.8	3	1.8	5.5
UWL-10PLD	Chromebook	10	Padlock	Yes	12.5	1.48	13.9	3.1	1.1	2.8	3	1.8	5.5
UWL-12KLD	Chromebook	12	Key lock	Yes	12.5	1.2	13.9	3.1	1.1	2.8	3	1.5	5.5
UWL-12PLD	Chromebook	12	Padlock	Yes	12.5	1.2	13.9	3.1	1.1	2.8	3	1.5	5.5

Maximum Wallmount Power Supply Dimensions

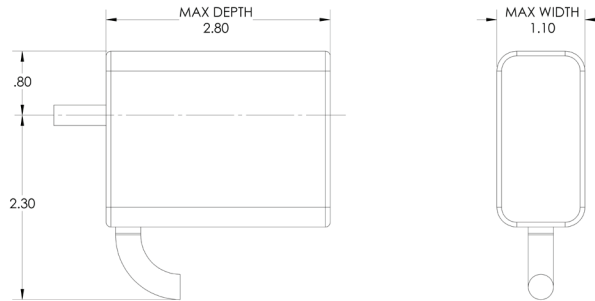

More Views of Wallmount Charging Lockers, Basic Charging



Front view



Back view



Side view



Front view, door open

Dimensional diagrams of the Wallmount Charging Lockers, Basic Charging

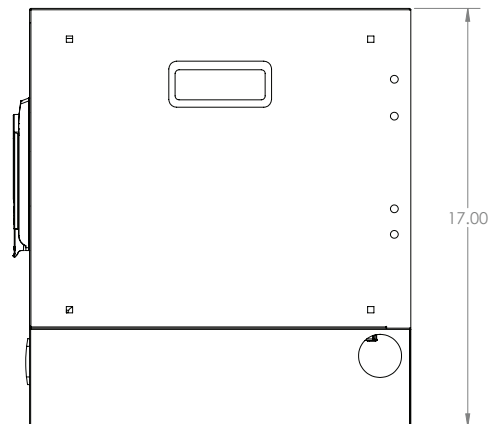
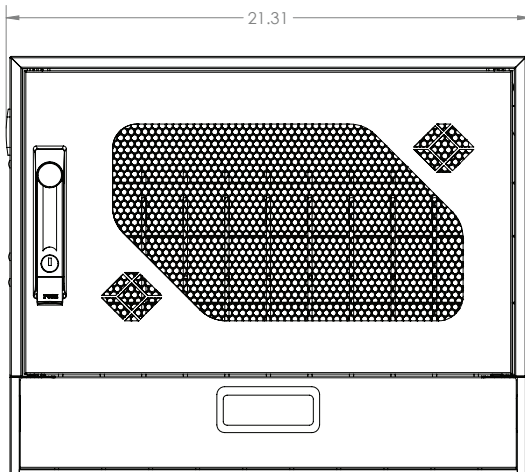
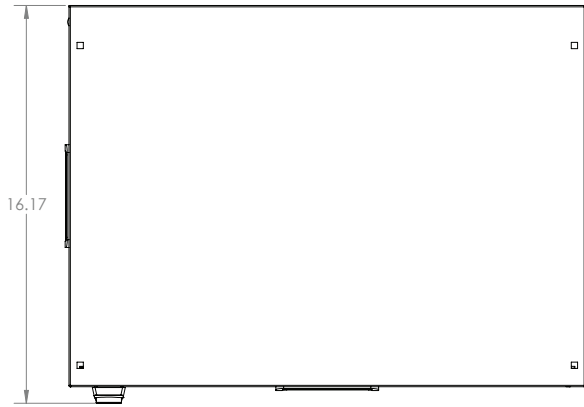

Disclaimer:

Black Box Network Services shall not be liable for damages of any kind, including, but not limited to, punitive, consequential or cost of cover damages, resulting from any errors in the product information or specifications set forth in this document and Black Box Network Services may revise this document at any time without notice.

About Black Box:

Black Box is a leading technology product solutions provider that helps customers build, manage, optimize, and secure their networks. The Black Box quality management system is ISO 9001:2015 certified, and the company has received numerous industry recognitions. Black Box provides its customers with free, 24/7 pre- and post-sales technical support. The Black Box catalog and Web site offer an extensive range of infrastructure products including Cabling, Cabinets & Racks, Data Center Cooling Solutions, Power & Surge Protection, and Environmental Monitoring.

© Copyright 2019. Black Box Corporation. All rights reserved. Black Box® and the Double Diamond logo are registered trademarks of BB Technologies, Inc. Any third-party trademarks appearing in this publication are acknowledged to be the property of their respective owners.